

Modular slip-ring motors, type NMK

Dimension drawings

1 < UN ≤ 6.6 kV, IM 1001, IC611 / IP55

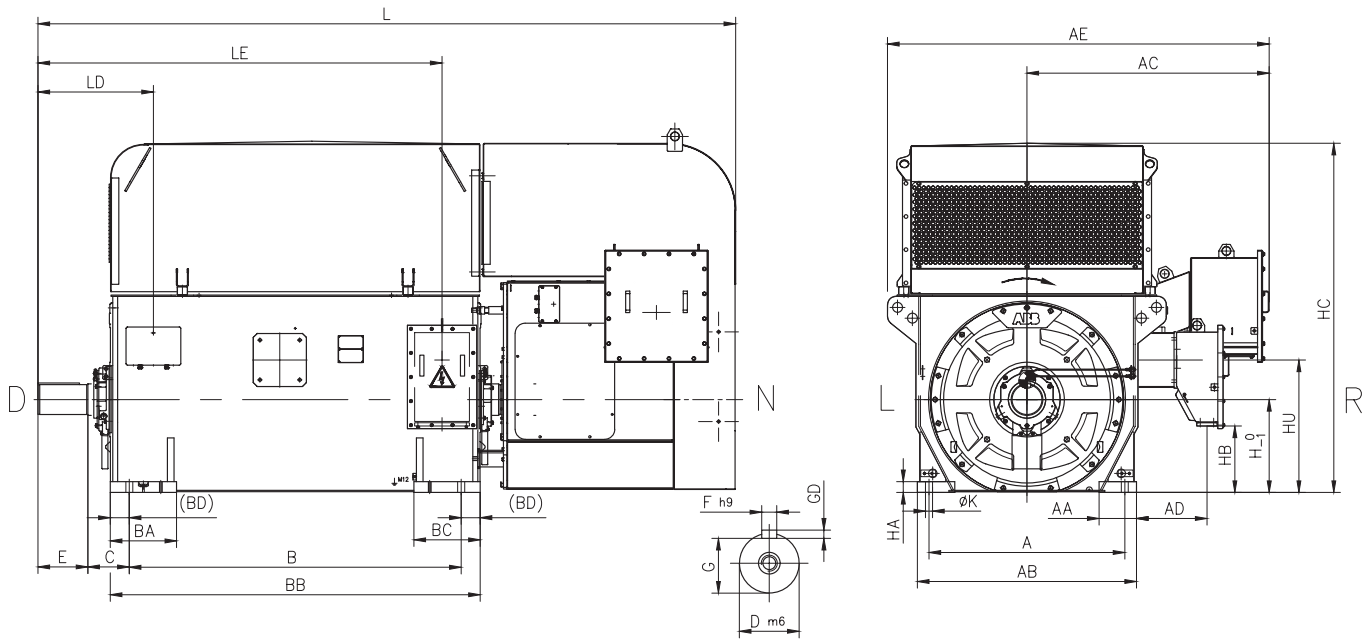

NMK	Poles	A	B	C	D	E	F	G	H	K	L	AA	AB	AC	AD	AE
400L	≥4	800	1340	200	110	210	28	100	400	36	2805	160	920	1195	310	1740
450L	≥4	950	1400	250	120	210	32	109	450	42	2985	185	1070	1195	285	1795
500L	≥4	1000	1600	250	140	250	36	128	500	42	3250	190	1170	1195	295	1840
560L	≥4	1180	2000	250	180	300	40	165	560	42	4210	225	1320	1460	425	2305
630L	≥4	1400	2240	250	200	350	45	185	630	42	4490	200	1500	1550	421	2485
710L	4	1600	2500	560	220	350	50	203	710	42	5420	200	1700	1910	795	2980
710L	≥6	1600	2500	355	220	350	50	203	710	42	5215	200	1700	1910	795	2980

NMK	Poles	BA	BB	BC	BD	GD	HA	HB	HC	LD	LE	HU	D-end bearing	N-end bearing
400L	≥4	250	1540	250	100	16	30	250	1595	580	1600	635	6324/C3	6228/C3
450L	≥4	270	1700	270	150	18	40	300	1740	610	1720	685	6326/C3	6228/C3
500L	≥4	280	1900	280	150	20	45	375	1930	675	2010	765	6330/C3	6330/C3
560L	≥4	400	2230	400	115	25	65	400	2190	695	2435	798.5	6038M/C3+NU1038M/C3	NU1038M/C3
630L	≥4	400	2470	400	115	25	65	500.5	2395	745	2725	948.5	6044M/C3+NU1044M/C3	NU1044M/C3
710L	4	400	2730	400	115	28	65	400	2555	1096	3290	980	FZLB18-225	FZLQ18-225
710L	≥6	400	2730	400	115	28	65	400	2555	891	3085	980	6048M/C3+NU1048M/C3	NU1048M/C3

Note: Preliminary dimensions of standard configuration in the list.

Note: Optional solutions e.g. NEMA oversize main terminal box, IM 1002, sleeve bearings, with BLD, etc. on request.

Note: Sleeve bearings with oil circulation are default for 4 pole machines on frame size 710 mm.

Note: Accurate dimension drawing will be given on customized solution at the quotation phase.

Table gives main dimensions in mm.